

- Intelligent Health Care
- Healthy Life

Infrared Sauna



# 909MX Infrared Sauna

## Installation & Owner's Manual

---

Please read this entire manual thoroughly before proceeding with the assembly.

---

---

# CATALOGS

- 01 ● PRECAUTIONS  
AND INSTRUCTION
- 02 ● INSTALLATION GUIDE
- 09 ● OTHER FUNCTIONS
- 10 ● CONTROL PANEL INSTRUCTION
- 11 ● SPECIFICATIONS

---

# PRECAUTIONS AND INSTRUCTION

## ATTENTION

Please read all instructions thoroughly before using.

Serious injury may result if ignore the following warning and instruction.

Basic precautions should always be followed when using this electrical equipment.

## DANGER

To avoid the risk of causing burns, fire, electric shock, or other injuries:

- Connect the power cord to a properly grounded outlet.
- Using only for its intended use as described in this manual.
- Don't use accessories not recommended by the manufacturer.
- Please disconnect the power after using.
- Please keep the electrical cord away from heated surfaces.

If the sauna is faulty, the supply cord or plug is damaged, please stop using it immediately.

## WARNINGS

- Don't stay longer than one hour.
- Don't put the sauna on a humid environment.
- Don't touch the heater directly with hands or body for a long time.
- Don't use any sharp tools on or near the heaters (severe damage may result).
- Placing the sauna on a flat surface.
- Unauthorized disassembly of the sauna is prohibited.
- People with health problems should consult a physician for prior to using the sauna. (Including acute diseases, malignant tumors, high blood pressure, heart disease, allergic dermatitis, pregnancy, etc.)
- This product is not intended for use by person (including children) with reduced physical, sensory or mental capabilities, or lack of adequate

---

experience knowledge, unless they have been given supervision or instruction concerning use of the appliance by a person responsible for their safety.

- Using a sauna after taking alcohol, drugs, or medication can lead to hyperthermia and increase the risk of death.
- If you are feeling uncomfortable, exit the sauna immediately and consult a doctor.
- Children should be supervised to ensure that they do not play with the appliance.

### **HYPERTHERMIA**

Prolonged exposure in the sauna may cause hyperthermia. Hyperthermia occurs when body's core temperature rises above 98.6F. Symptoms of hyperthermia include a rise in body temperature, dizziness, lethargy, drowsiness, and fainting. The effects of hyperthermia may include:

- a) Failure to perceive heat / Unawareness of impending heat
- b) Failure to recognize the need to exit the sauna
- c) Fetal damage in pregnant women
- d) Physical inability to exit the sauna
- e) Unconsciousness

## **INSTALLATION GUIDE**

Each panel is heavy, especially the top panel. Be careful to avoid injury when installing. This sauna requires at least 2 adults to complete assembly. The panels should be install in the following order:

Floor Panel → Rear Panel → Left Side Panel → Right Side Panel → Left Side glass → Install the Door handle → Bench Support Panel → Bench Surface Panel → Front Panel → Install the top → Connect the wires

---

### Step 1: Position the Floor Panel



(image1)

Place the floor panel on a flat surface. Before assembly, make sure the floor is flat so that you can maintain a comfortable subsequent installation. (image1)

### Step 2: Position the Rear Panel



(image2)

Place the rear panel in place so that the wooden strip at the bottom of the rear panel is clamped to the floor panel. If your sauna is next to a wall, you can gently rest the rear panel against the wall of your home. (image 2)

### Step 3: Position the Left Side Panel



(image3)

Place the left side panel in place so that the wooden strip at the bottom of the left side panel is clamped to the floor panel. Pay attention to whether the hooks of the rear and left side panel sub-button are up or down. (image 3)

---

#### Step 4: Position the Right Side Panel

Place the right panel into the slot of the floor panel and push it towards the rear panel. Check whether the hooks of the fasteners are up or down, and the fasteners are connected together as shown. (image 4)



(image 4)

#### Step 5: Position the Left Side glass

Please install the screws to fix the glass as shown in the diagram. First, insert the white plastic part into the hole, then tighten the screw, and finally cover it with the screw cap. (image 5)



(image 5)

---

### Step 6: Install the Door handle

Please install according to the photo and tighten the door handle, so it can be used. (image 9)



(image 9)

### Step 7: Place the Bench Support Panel

Place the Bench Support panel (image10&11) and connect the wires behind (image12&13). Each two wires have corresponding unique interface shape, hear a click to indicate that the connection is completed.



(image 10)



(image 11)



(image 12)



(image 13)

---

### Step 8: Place the Bench Surface Panel

Place the bench surface panel (image 11), and please make sure to always install the Bench Surface panel before installing the Front Panel, otherwise it will not fit inside due to space limitations.



(image11)

### Step 9: Place the Front Panel

Please install the glass seal strip on the front panel first, then place the front panel into the slot on the base. Attach the other end of the glass seal strip to the glass on the side panel.

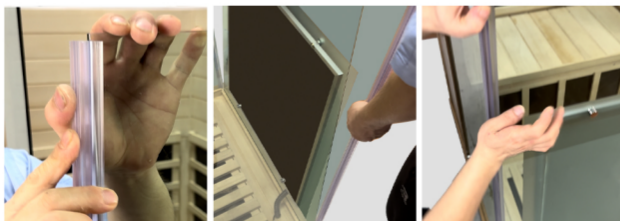



---

### Step 10: Place the Front Panel

Please check if the front door is assembled and connect the heating panel on the door with the connection port on the bottom.

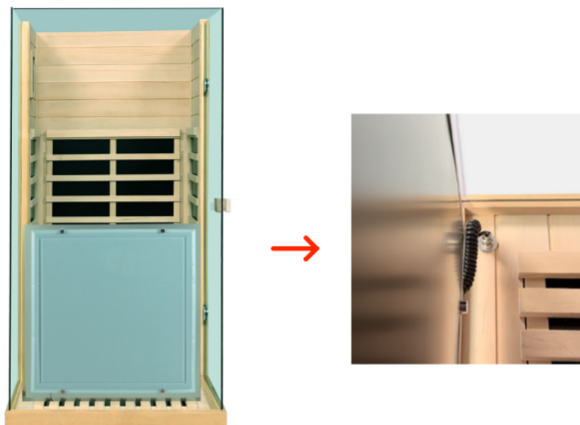

### Step 11: Install the top

Please install the top of the sauna. Make sure that all wires on the side panel through the holes.



---

### Step 12: Connect the wires

Please connect all the wire ports. After connecting, pull them slightly to check for looseness.



(image12)

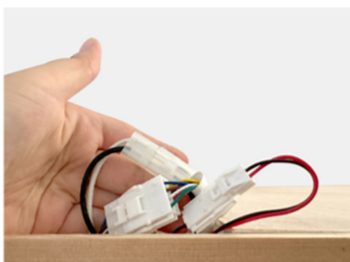

(image13)

### Step 13: Enjoy your Sauna

Congratulations, you have successfully assembled a sauna. Plug in the sauna, and enjoy your sauna time.



---

## OTHER FUNCTIONS



Mid-infrared lamp



Reading lamp



Vent



Bluetooth

⌘ :BT SPEAKER

# CONTROL PANEL INSTRUCTION

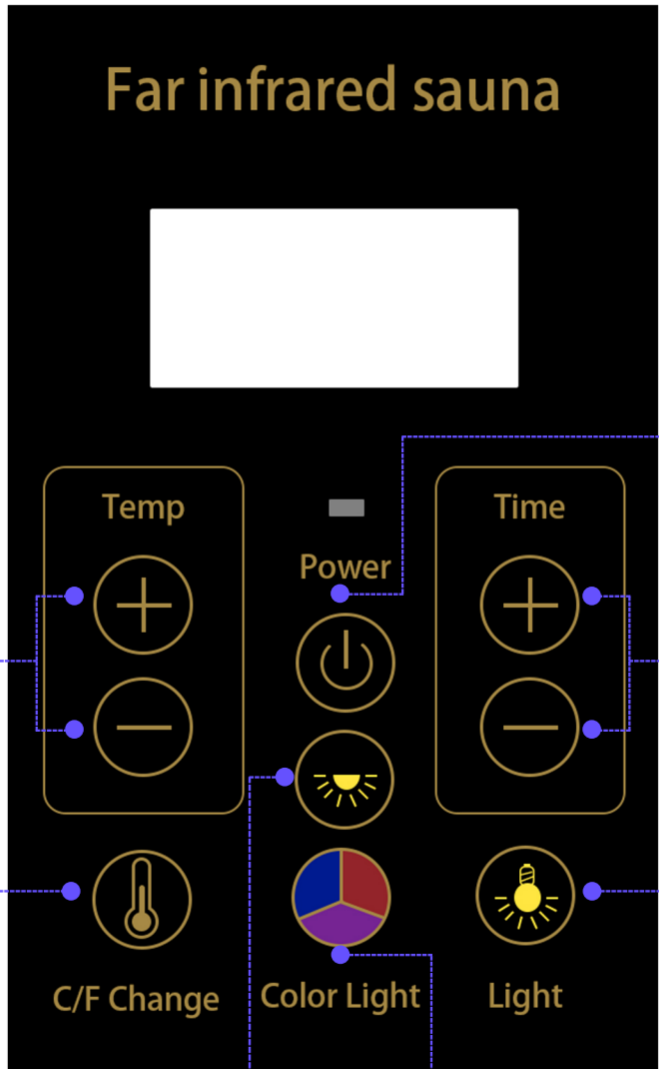

---

# SPECIFICATIONS

Product Name	Far Infrared Sauna
Model	909MX
Dimensions	36.5*32.3*66.6 in
Voltage	110-120VAC
Plug Type	15 Amps
Wattage	1100 W
Number of Heaters	6 pcs
Raw Material	Hemlock/Red Cedar
Location	Indoor

# ABOUT MID-INFRARED LAMPS

1. Visible red or blue light and near infrared light have a positive effect on skin wound healing.
2. Near-infrared light can promote collagen synthesis, hydration, reduce wrinkles and achieve skin rejuvenation.

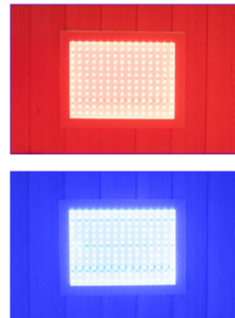
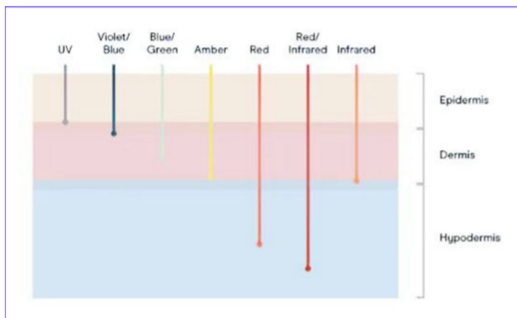

3. Whole-body red light therapy is effective in promoting wound healing in deep burn wounds and other similar acute wounds. At the same time, it has pain-relieving and safety benefits for these patients.
4. Mid-infrared light can promote blood circulation, improve acne and inhibit melanin production.

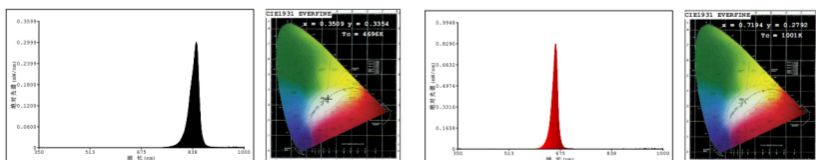

# WARRANTY CERTIFICATE

Please complete the following details and send back  
with the original item/parts with safety package.

Client's Name: \_\_\_\_\_

Address: \_\_\_\_\_

City: \_\_\_\_\_ State: \_\_\_\_\_

Postcode: \_\_\_\_\_ Model No: \_\_\_\_\_

Telephone: \_\_\_\_\_ Order No: \_\_\_\_\_

Date of Purchase: \_\_\_\_\_

Store from which product was purchased: \_\_\_\_\_

Problem Description: \_\_\_\_\_

\_\_\_\_\_

- We provide 1year free maintain service for part of main electric equipment from when your purchase, please enclose this warranty card when you return back. Without this warranty card or change the warranty card, the maintain will not be provided.

**CONCENTRATE ON PROFESSIONAL SAUNA**